

LK



Datasheet

INDEX

Specification..... 2
 Description..... 3
 Tapping overview..... 4
 Illustrations..... 4
 Dimensions..... 4
 Installation options..... 6
 Output..... 7
 Accessories 7

SPECIFICATION

HOW TO SPECIFY AN ITEM

Item number example 151012210

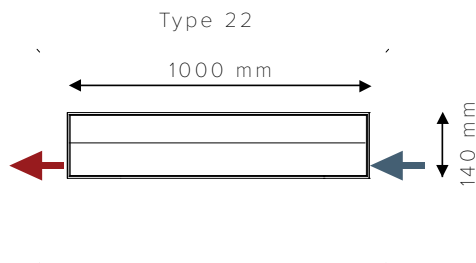
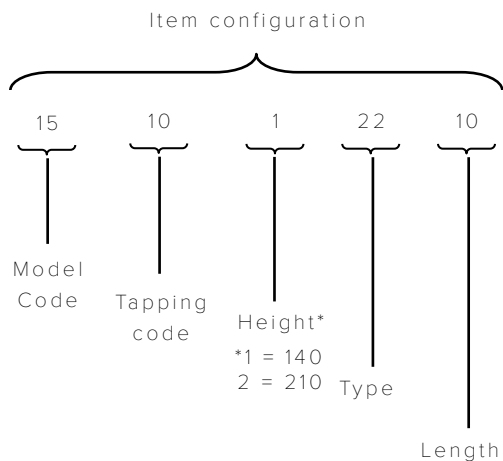

Note

Thermostat sensor head is not included in the product - should be ordered separately.

DESCRIPTION

Hudevad LK is a low convector radiator made of profiled steel tubes. The radiator has a flat, sleek design on both the rear and front side, making it ideal for use in front of glazing. Hudevad LK is available in two heights. It is suitable for installation on the wall, floor, in a convector trench, under bench seating, or under the ceiling.

Material	Panels: Profiled steel tubes 70 x 11 x 2 mm, EN 10130 Convectors: 0.5 mm steel plates EN 10051, EN 10130, DIN 2395
Test pressure	13 bar
Max. operating pressure	10 bar - in accordance with EN 442
Max. operating temperature	95°C
Warranty	10 years
Surface treatment	Pre-treatment by degreasing and steel phosphating. Powder coated in accordance with DIN 55900, EN 442.
Type	20 and 30
Height	140 and 210 mm For 70 mm height please see LK Mini
Length	Type 20: 1000 - 2000 mm Type 30: 800 - 2000 mm
Depth	84 and 157 mm
Connections	All tappings 1/2" standard (adapters available)
Installation	Wall or floor mounted. Brackets are included
Mounting straps	No mounting straps
Colour	Powder coated in white RAL 9010, gloss 70 Option: Painted in other colours. Please see the Hudevad Radiator Design Colour Brochure at www.hudevad.com
Options	Feet and shelf brackets

TAPPING OVERVIEW

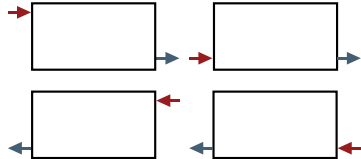
Tapping code	Tapping type	Tapping possibilities
10	ABCD (4 tap)	

ILLUSTRATIONS

VIEW FROM THE FRONT

Drawing 4.1

Type 20

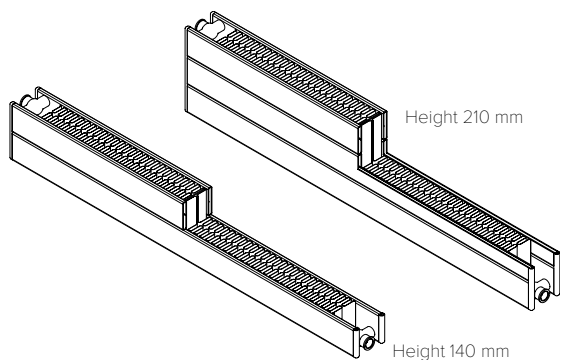

Type 30

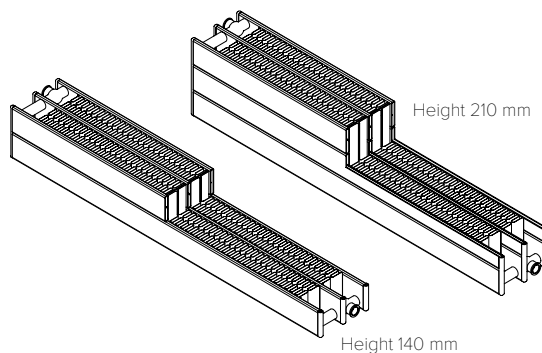

DIMENSIONS

Drawing 4.2

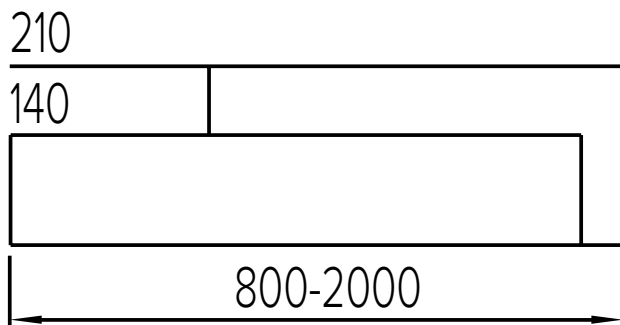

DEPTH

Type 20

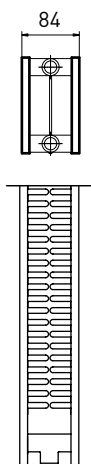

Type 30

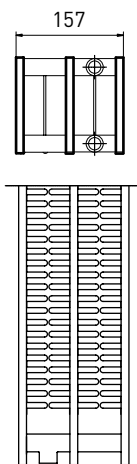

Drawing 5.1

BUILD-IN DIMENSIONS

Type 20

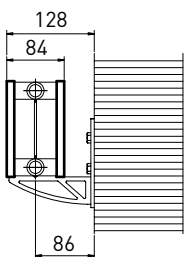

Type 30

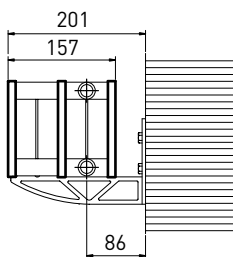

Drawing 5.2

MOUNTING BRACKET DIMENSION

Type 20

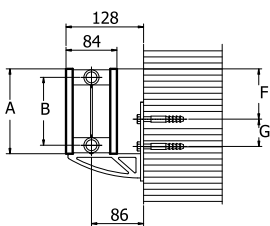

Type 30

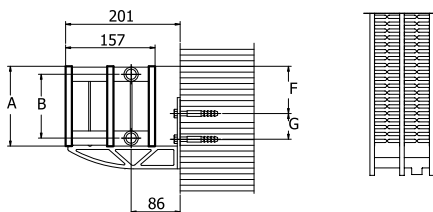

Drawing 5.3

Measurement diagram

LK type	Type 20/30	Type 20/30
A (height)	140	210
B (center distance)	108	178
F	83+10	153+10
G	45	45

INSTALLATION OPTIONS

MOUNTED IN CEILING

When mounting on ceiling, additional 10°C air and room temperature is used in calculation, which means Δt is 10°C lower than a corresponding floor mounting.

MOUNTED IN TRENCH

When mounting in trench, the table value for the output is reduced by approximately 20%, and to ensure the air circulation conductor plates are attached from the convector side to the under-edge of the grille. By doing that there is a division between the hot rising air and the cold descending air.

In trench: Heating of cold window zone and the remaining room

Fig. 1

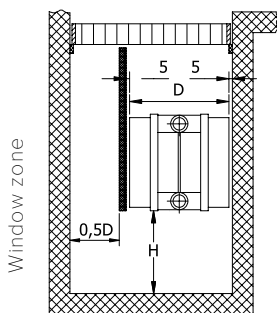

In trench: Heating of cold window zone and the remaining room

Fig. 2

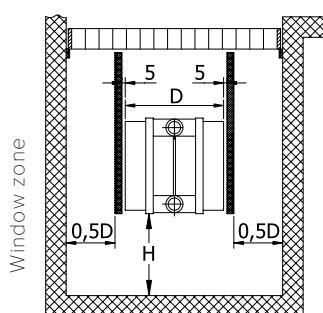

Underneath ceiling: Heating of cold window zone and the remaining room

Fig. 3

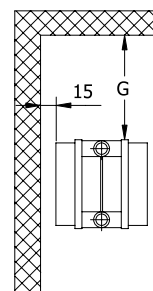

Drawing 6.1

LK type	G-measurement min. (mm)	H-measurement min. (mm)	Trench depth min. (mm)	Trench depth min. (mm)	Trench depth min. (mm)
Type 20	100	120	280	145 Fig. 1	196 Fig. 2
Type 30	125	120	280	253	340

OUTPUT

TAPPING CODE 10

LK TYPE 20

Height, mm	Output			Water content	Weight
	W/metre 75°/65°/20°	W/metre 70°/40°/20°	W/metre 60°/30°/20°	litres/ metre	kg/ metre
140	594	357	216	1.80	13.5
210	757	440	258	2.60	20.4

LK TYPE 30

Height, mm	Output			Water content	Weight
	W/metre 75°/65°/20°	W/metre 70°/40°/20°	W/metre 60°/30°/20°	litres/ metre	kg/ metre
140	1021	598	353	2.8	24.8
210	1314	764	448	4.0	33.0

ACCESSORIES

LK FEET

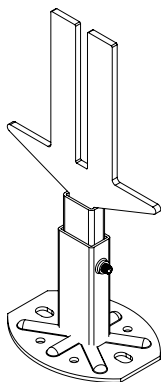

BRACKET

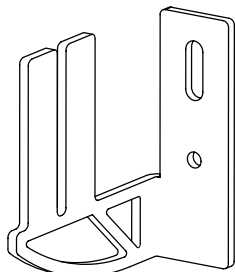

SHELF BRACKET

Drawing 71

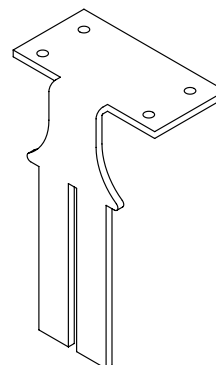

DANFOSS ACCESSORIES

Drawing 72

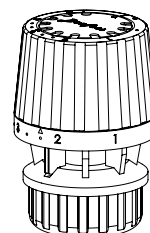
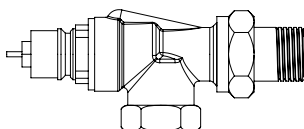
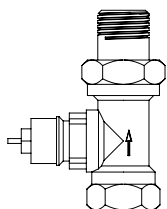

Hudevad recommends use of Danfoss accessories when fitting the radiator. For further accessories please refer to the Hudevad Pricelist.